

Vivinex[®] iSert[®] Model XC1

Preloaded System
Hydrophobic Acrylic IOL

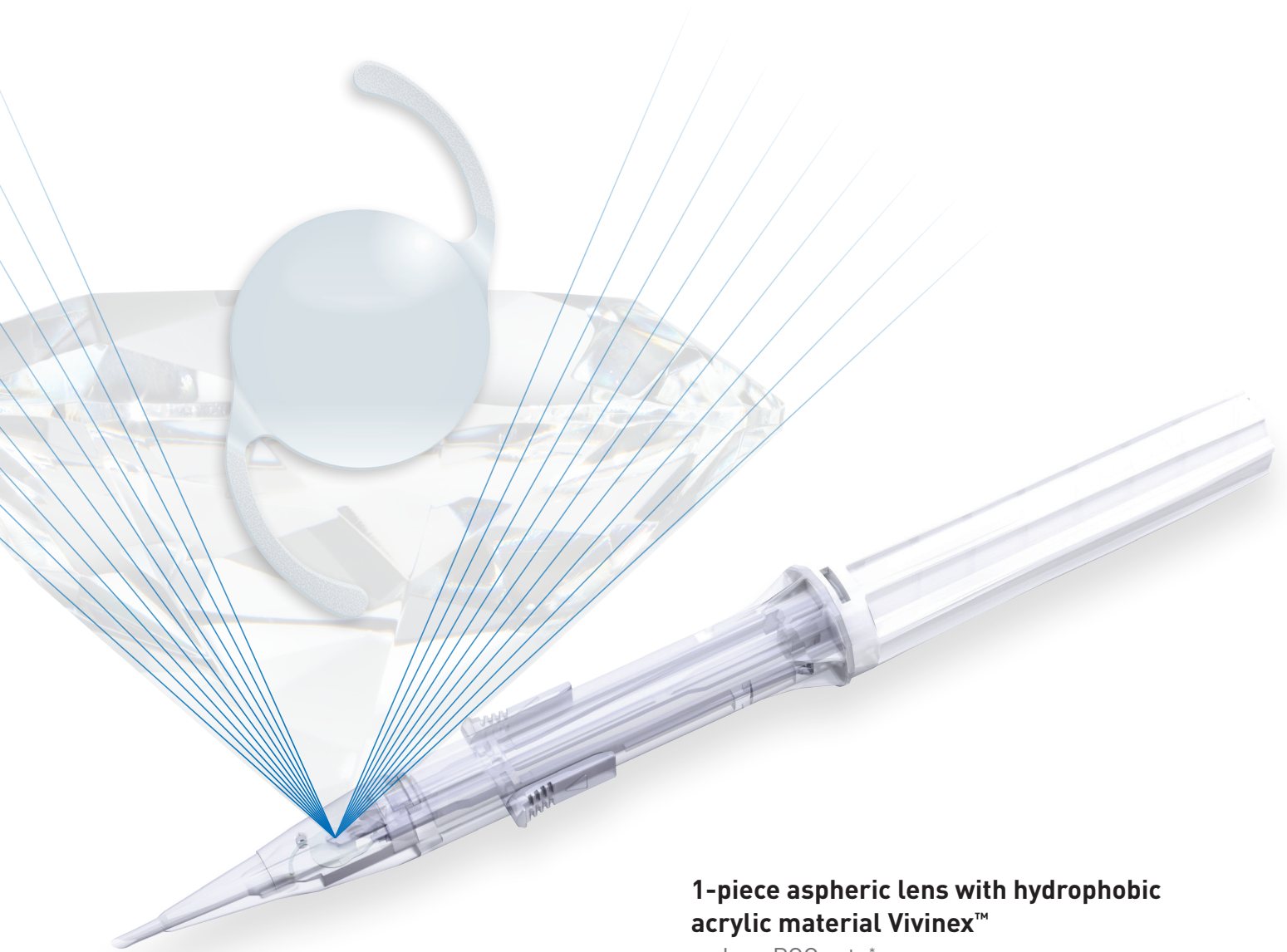

1-piece aspheric lens with hydrophobic acrylic material Vivinex[™]

- Low PCO rate*
- Long term transparency based on in vitro tests**

Distinctive IOL design

- Sharp textured optic edge
- Textured-rough haptics
- Aspheric ABC Design

Vivinex[®] iSert[®] Model XC1

Preloaded System
Hydrophobic Acrylic IOL

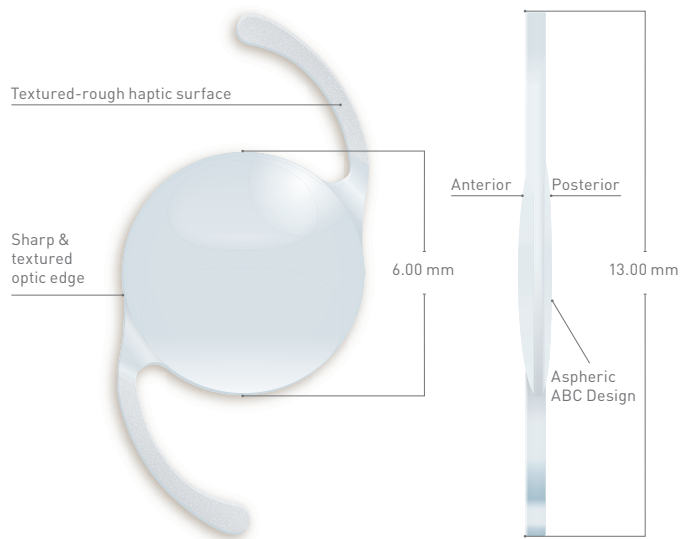

Model Name	Vivinex [™] iSert [®] XC1
Optic Design	Aspheric ABC Design with sharp textured optic edge
Optic & Haptic Materials	Hydrophobic acrylic Vivinex [™] with UV filter
Haptic Design	textured-rough haptic surface
Dimension (Optic/OAL)	6.00 mm/13.00 mm
Power	+6.00 to +30.00 D (in 0.50D increments)
Nominal A-Constant***	118.9
Optimized Constants****	Haigis a0 = -0.905 a1 = 0.230 a2 = 0.229 Hoffer Q pACD = 5.74 Holladay 1 sf = 1.98 SRK/T A = 119.2 SRK II A = 119.5
Front injector tip outer diameter	1.70 mm

- * Japanese clinical study carried out from 2009 to 2011: internal report
 ** Study result of the The David J Apple International Laboratory for Ocular Pathology, University Hospital Heidelberg. Report on file
 *** The A Constant mentioned above is presented as a guideline only for lens power calculations. It is recommended that the A Constant measurement be customized based on the surgeon's experience and measuring equipment.
 **** Calculated from 531 patient data on file. (as of Dec. 9, 2016)



The handling shown below illustrates in summary the product application and does not replace the Instruction For Use.

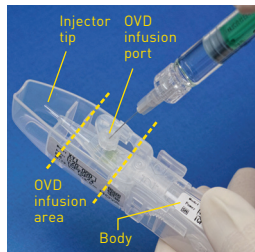

Step A

Infuse the OVD into the injector through the infusion port. Fill up the area indicated by dotted lines.



Step B

Press the release tabs, lift up and remove the cover from the case.

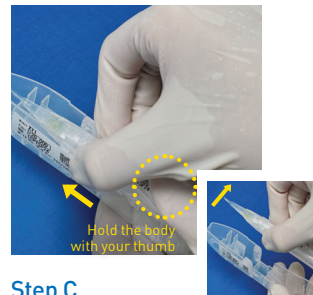

Step C

Hold body with thumb and push the slider slowly forward until it stops. Remove the injector from the case.

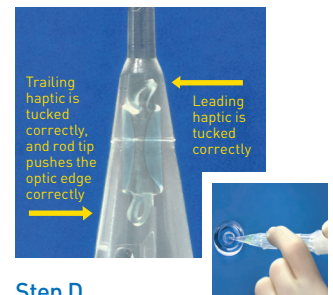

Step D

Carefully insert the injector tip into the eye through the incision, keeping the slit of the tip in a downward position. Slowly rotate the injector knob clockwise, to inject the lens into the capsular bag.

Singularly Focused. Globally Powered.[™]

HOYA Surgical Optics names and logos are registered trademarks of HOYA Surgical Optics, Inc.
 ©2017 HOYA Surgical Optics, Inc. All rights reserved.

HOYA Surgical Optics GmbH | EMEA Headquarters | De-Saint-Exupéry-Str. 8 | 60549 Frankfurt/Main | Germany
 HOYA.com/SurgicalOptics



2017-04-21_HSOE_XC1_DS_EN

HOYA
SURGICAL OPTICS