

# Vivinex<sup>®</sup> iSert<sup>®</sup> Model XY1

Preloaded System  
Hydrophobic Acrylic IOL

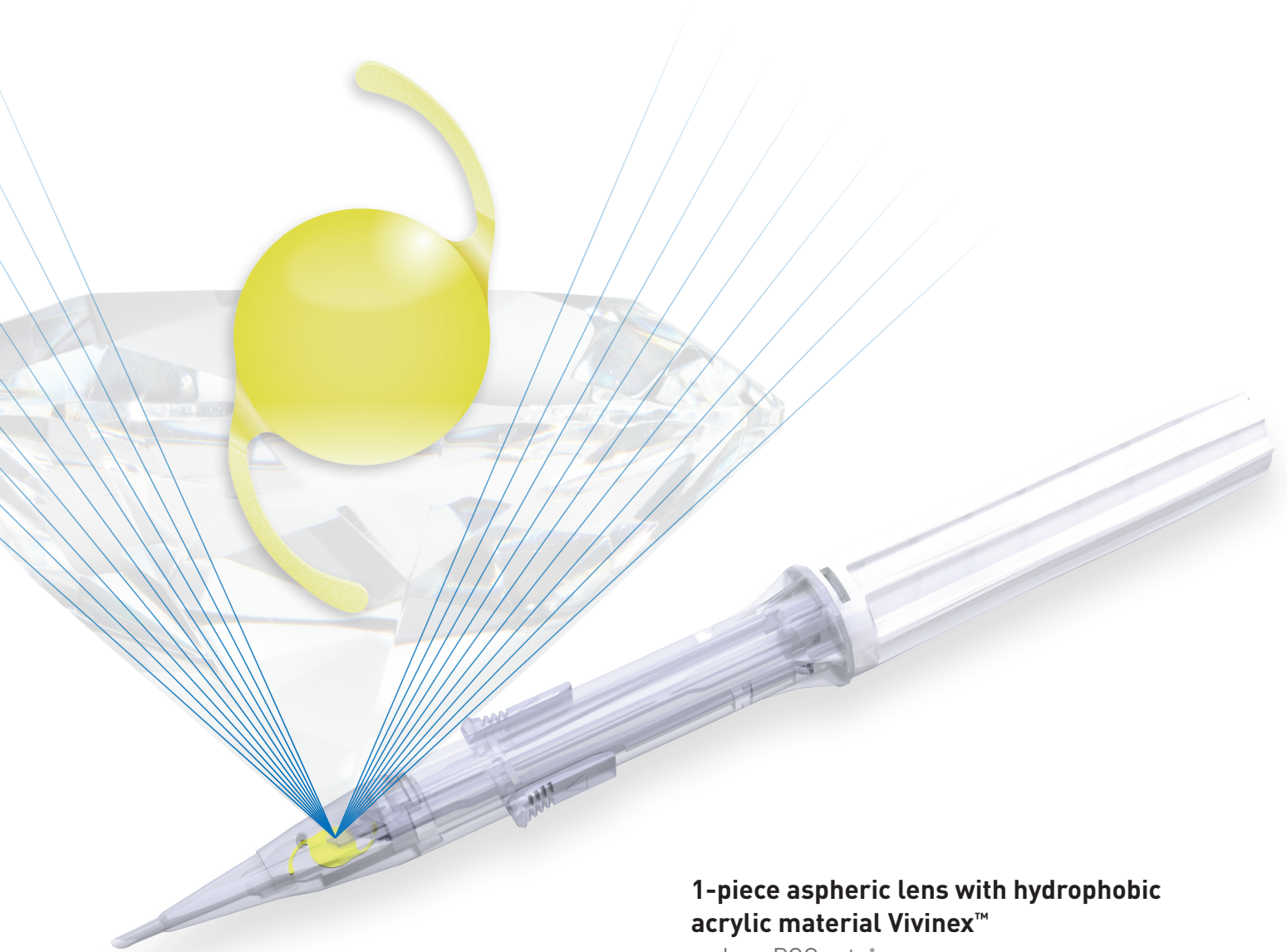

## 1-piece aspheric lens with hydrophobic acrylic material Vivinex<sup>™</sup>

- Low PCO rate\*
- Long term transparency based on in vitro tests\*\*

## Distinctive IOL design

- Sharp textured optic edge
- Textured-rough haptics
- Aspheric ABC Design

# Vivonex<sup>®</sup> iSert<sup>®</sup> Model XY1

Preloaded System  
Hydrophobic Acrylic IOL

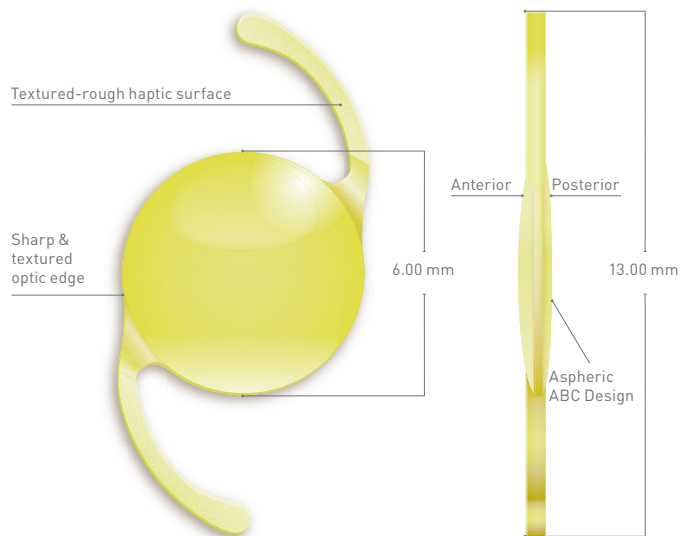

Model Name	Vivonex <sup>™</sup> iSert <sup>®</sup> XY1
Optic Design	Aspheric ABC Design with sharp textured optic edge
Optic & Haptic Materials	Hydrophobic acrylic Vivonex <sup>™</sup> with blue light filter
Haptic Design	textured-rough haptic surface
Dimension (Optic/OAL)	6.00 mm/13.00 mm
Power	+6.00 to +30.00 D (in 0.5D increments)
Nominal A-Constant***	118.9
Optimized Constants****	Haigis a0 = -0.905 a1 = 0.230 a2 = 0.229 Hoffer Q pACD = 5.74 Holladay 1 sf = 1.98 SRK/T A = 119.2 SRK II A = 119.5
Front injector tip outer diameter	1.70 mm

- \* Japanese clinical study carried out from 2009 to 2011: internal report  
 \*\* Study result of the The David J Apple International Laboratory for Ocular Pathology, University Hospital Heidelberg. Report on file  
 \*\*\* The A Constant mentioned above is presented as a guideline only for lens power calculations. It is recommended that the A Constant measurement be customized based on the surgeon's experience and measuring equipment.  
 \*\*\*\* Calculated from 531 patient data on file. (as of Dec. 9, 2016)



The handling shown below illustrates in summary the product application and does not replace the Instruction For Use.

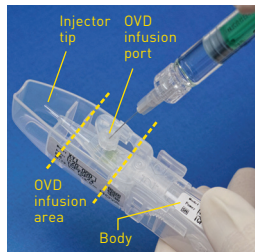

## Step A

Infuse the OVD into the injector through the infusion port. Fill up the area indicated by dotted lines.



## Step B

Press the release tabs, lift up and remove the cover from the case.

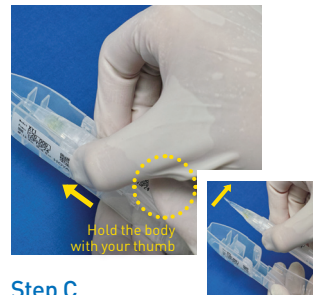

## Step C

Hold body with thumb and push the slider slowly forward until it stops. Remove the injector from the case.

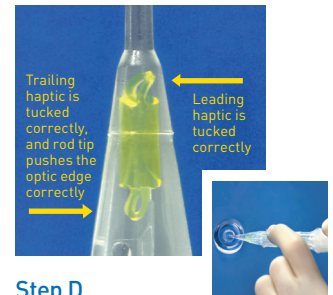

## Step D

Carefully insert the injector tip into the eye through the incision, keeping the slit of the tip in a downward position. Slowly rotate the injector knob clockwise, to inject the lens into the capsular bag.

Singularly Focused. Globally Powered.<sup>™</sup>

HOYA Surgical Optics names and logos are registered trademarks of HOYA Surgical Optics, Inc.  
 ©2017 HOYA Surgical Optics, Inc. All rights reserved.

HOYA Surgical Optics GmbH | EMEA Headquarters | De-Saint-Exupéry-Str. 8 | 60549 Frankfurt/Main | Germany  
 HOYA.com/SurgicalOptics



2017-04-21\_HS0E\_XY1\_DS\_EN

**HOYA**  
SURGICAL OPTICS